

SPECIAL CYLINDERS

Double Acting Telescopic Cylinders

2 Stage Double Acting Telescopic (DTR60-2)

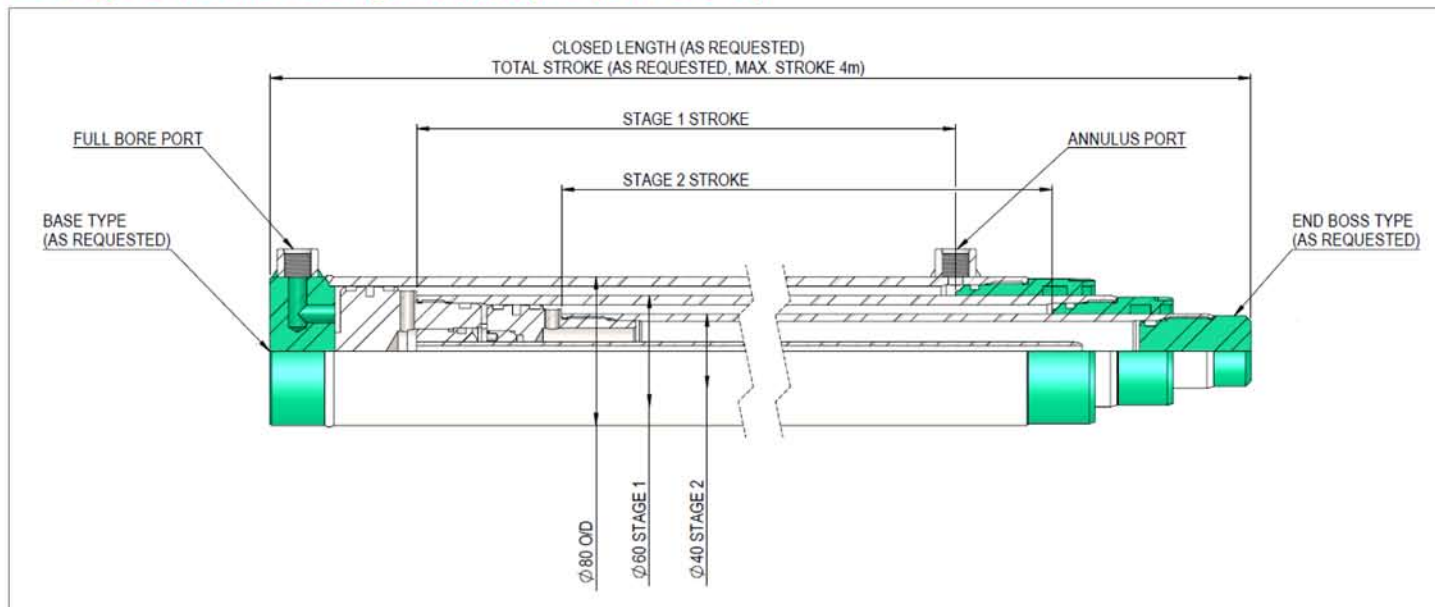

3 Stage Double Acting Telescopic (DTR80-3)

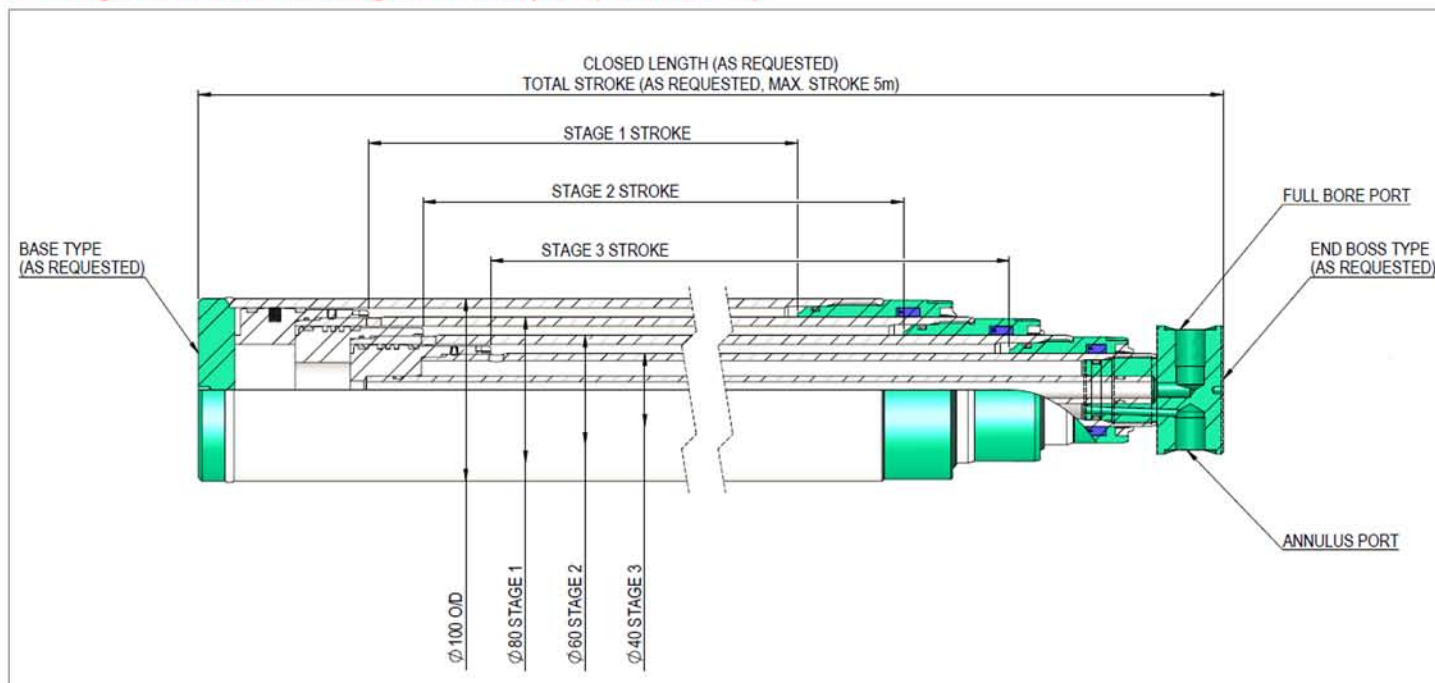

Double acting telescopic cylinders are designed to enable the retraction of the extended tube assembly under minimal load. They are not designed to pull heavy loads and are speed restricted due to the internal back pressures generated inside.

For technical information please contact technical sales.